

**1**  
Lightly tug on the handle of the support chair to release it from its holding place. The front panel will then fall open in the direction towards you.

**2**  
Please ensure that the front panel has touched the floor fully before sitting onto the support chair. (Always maintain support on the handle till the end.)

**3**  
Only release the grip on the handle of the support chair only after a "clack" sound is heard.

※Please use only the handle for pulling out and storing of the support chair.

### Warning

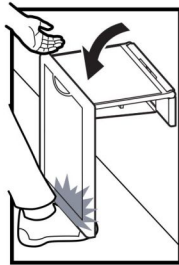
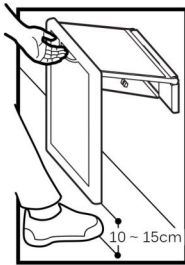

There is a damper installed in the support chair that causes the chair to fall open slowly. But once the support chair is released from its holding place, it is difficult to control the falling speed of the chair especially when the chair is about 10~15cm away from the ground.

So, please do not let go of the handle when storing the chair away to avoid damaging the floor or feet injuries.

### Attention



The load capacity of the chair is up to 150kg. Any load heavier than 150kg might damage the product.



Please do not use the support chair as a kid's playground or any other purposes apart from sitting only. Also, avoid leaning on the mirror as too much pressure may lead to product damage and unexpected injuries.



Always use the handle when pulling out or storing the support chair to avoid fingers being sandwiched between the chair.

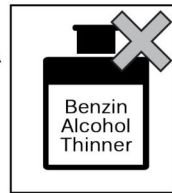

Do not use gasoline (benzin), alcohol or thinner to clean the product. A damp cloth with a bit of synthetic detergent will suffice for maintenance.

※Please do not allow a child to use the chair alone. Always have an adult nearby to provide support.

### Important Notice before and after Installation

1. Please ensure that reinforcements of the wall surface have been made before installing the support chair and full length mirror. (Installation on plaster board is dangerous, so please avoid it at all cost.)
2. Please check that all products are secured properly and product is in good working condition after installation before using the product.
3. Please do not dismantle any parts or make unnecessary modifications to the product as it may lead to product malfunctioning and injuries.

## Installing Instructions for AS359

### Base Plate Installation <Plywood Panel Reinforcement>

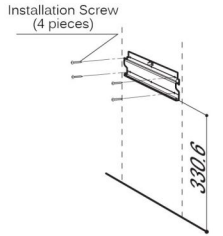

For plywood reinforcement panel thicker than 9mm, install the base plate with the 4 screws provided at both ends of the plate.

### Base Plate Installation <Wood Pillar Reinforcement>

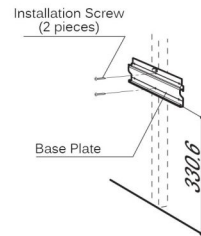

For wood pillar reinforcement more than 40x50mm in size, please install the base plate with the 2 screws provided at the center of the plate.

### AS359 Main Body Installation

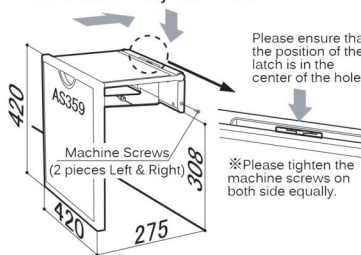

Cover the base plate with the main body of the support chair and fix it in place, but please do not tighten the screws completely until the machine screws on both sides of the main body is completely tightened. While tightening the screws on the left and right side, please check that the position of the latch is in the center of the hole.

### Adjuster Adjustment

**Important**  
Make adjustments only when horizontal level of surface cannot be achieved. Wobbling of adjuster might cause product damage and injury to user.

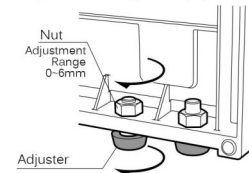

In the events of a drainage incline or a small step raise in the floor level, loosen the nut and lengthen the adjuster slightly. Once adjustment is completed, please remember to tighten the nut again.

### Operation Check

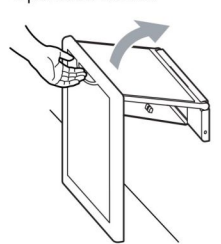

Once installation is complete, please check the operation of the support chair by opening and storing the chair several times.

## Opening the AS359

### Opening of the support chair before installation

After removing the product from its package, open the support chair by pulling on the ditch located in the base plate upwards.

※(Supporting the lower portion of the base plate will make pulling the chair out easier.)

**Important**  
Please do not open the support chair via places other than the ditch in the base plate. Product deformation leading to operation failure may occur.

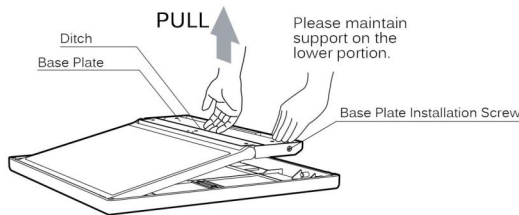

Once open, remove the base plate with a plus screw driver.

## Latch Adjustment

### Latch fitting adjustments after installation

Adjustments can be made to the support chair seat's catching strength just by tweaking the screw of the latch located under the seat of the support chair. To tighten the catch, turn the screw in the clockwise direction with a plus screw driver or turn the screw in the anti-clockwise direction to loosen.

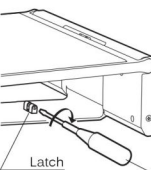

**Important**  
Constantly check the release and storing of the seat when making adjustments to the catch strength of the support chair seat. Please proceed with care as latch shaving might occur if the screw is over tightened.

Minus Screw Driver

## Installing Instructions for AS559

### 1. Metal Fixture Installation for Mirror

<Plywood Panel/Wood Pillar Reinforcement>

With the support chair in the kept state, position and fix the metal fixture at least a 3mm distance above the support chair with the installation screws provided. As for the hook, align and fix the hook 1129.5mm above the metal fixture with the installation screws provided.

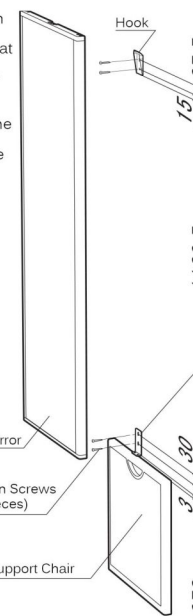

### 2. Hanging up the Mirror

Place the full length mirror onto the wall and slide it downwards to allow the hook to catch onto the mirror. ※There is not top and bottom definition for the mirror. The design is unified for both sides.

### 3. Fixing the Mirror

Secure the bottom of the mirror in place with the two installation screws provided. ※(Please open up the support chair before fixing the mirror in place.)

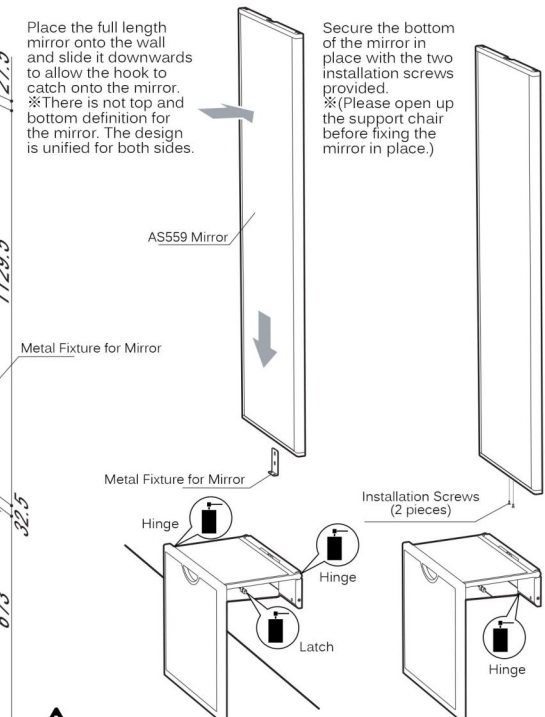

**Important**  
Please confirm groundwork reinforcement before installation.

**Important**  
1. If support chair is not installed properly, the risk of product falling off the installation surface and causing injuries is high.  
2. When movement of support chair or latch becomes stiff, oil the spots illustrated in the image above with CRC-556 or similar.  
※CRC-556 = Lubricating oil